

STAR

3.0

2.0

catalogue 2021

STARGRES®

once upon a time  
in Poland...

KONSKIE  
GROUP

1976

Mr Mirosław Szymański after graduation begins work in the ceramic factory in Opoczno city.

1980

He becomes the chief mechanic of ZZPC Opoczno and later the Technical Director.

1989

Jubilee tile in thanks for years of work.



During the political changes in Poland, he sets up Cerrol, a company with four work colleagues, which manufactures double firing tiles. The company is looking for a semi-finished product (biscuit) in Italy, because a recent employer from Opoczno does not want to sell it "private" competition.

1994

Cerart Studio is created a decoration manufacturer complementing wall collections.

1996

Polish partners establish Ceramika Końskie, which is joined by Adriano Frascari, the owner of a biscuit company



2000

They launch the largest biscuit factory in Europe. After several years, production reaches 9 million m<sup>2</sup> per year. They also sell biscuits to other producers in Poland and abroad.

Cotto  Petrus

2004

Mirosław Szymański receives the Honorary Badge of Merit for Construction from the Ministry of Infrastructure.



Mirosław Szymański is awarded the Silver Cross of Merit by the President of the Republic of Poland.

2005

The owners set up the company Stargres where the production of stoneware is started. At the beginning only 33x33cm format.

stargres

2008

Partners take over Ceramika Color. The total production of wall tiles reaches 6 million m<sup>2</sup> per year.

  
CERAMIKA  
COLOR

2014

Stargres is the first producer in Poland to start producing 2 cm thick stoneware.

STAR  
2.0

2019

Stargres is the first in Poland and the second in the world to introduce a 3 cm thick tile.

STAR  
3.0

2020

The Group refines the technology of wall tile production by introducing a white mass.

Creation of a new brand which is Ceramica Bianca.

CERAMICA  BIANCA

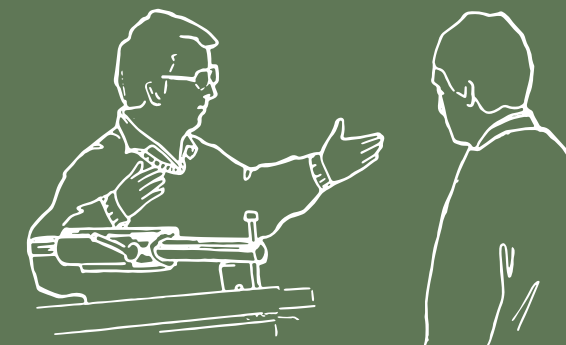

From one pallet per day in 1989 year up to **27 mln m<sup>2</sup>** of annual production after 30 years.

STAR  
3.0

STAR  
2.0

STARGRES®



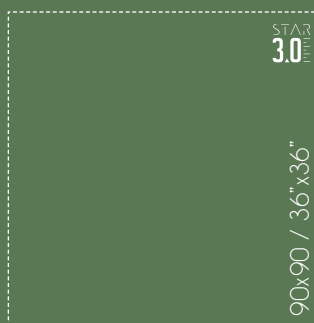

|                |    |
|----------------|----|
| danzig         | 16 |
| downtown       | 22 |
| downtown decor | 24 |
| pizarra        | 12 |



|               |    |
|---------------|----|
| danzig        | 16 |
| halifax       | 40 |
| pietra serena | 26 |
| suomi         | 36 |
| town          | 50 |
| vals          | 44 |



|               |    |
|---------------|----|
| danzig        | 16 |
| downtown      | 22 |
| pietra serena | 26 |
| pizarra       | 12 |
| select        | 30 |
| select decor  | 34 |
| spectre       | 48 |
| town          | 50 |

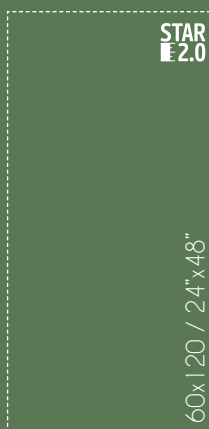

|               |    |
|---------------|----|
| pietra serena | 26 |
| pizarra       | 12 |
| select        | 30 |

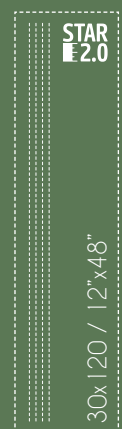

|               |    |
|---------------|----|
| pietra serena | 26 |
| step tiles    |    |



|               |    |
|---------------|----|
| danzig        | 16 |
| downtown      | 22 |
| pietra serena | 26 |
| select        | 30 |
| spectre       | 48 |
| town          | 50 |

|                |    |
|----------------|----|
| pizarra        | 12 |
| danzig         | 16 |
| downtown       | 22 |
| downtown decor | 24 |
| pietra serena  | 26 |
| select         | 30 |
| select decor   | 34 |
| suomi          | 36 |
| halifax        | 40 |
| vals           | 44 |
| spectre        | 48 |
| town           | 50 |

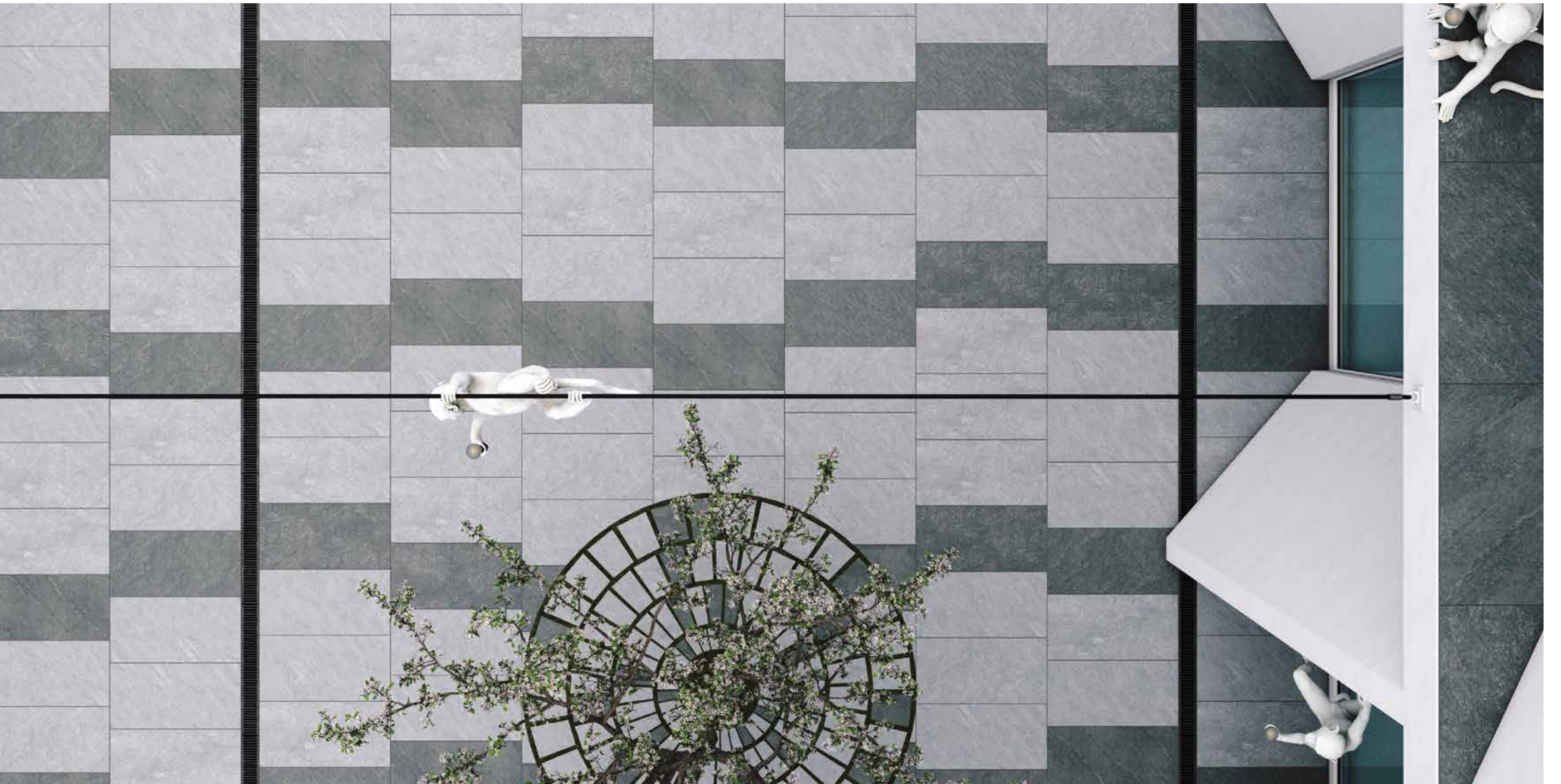

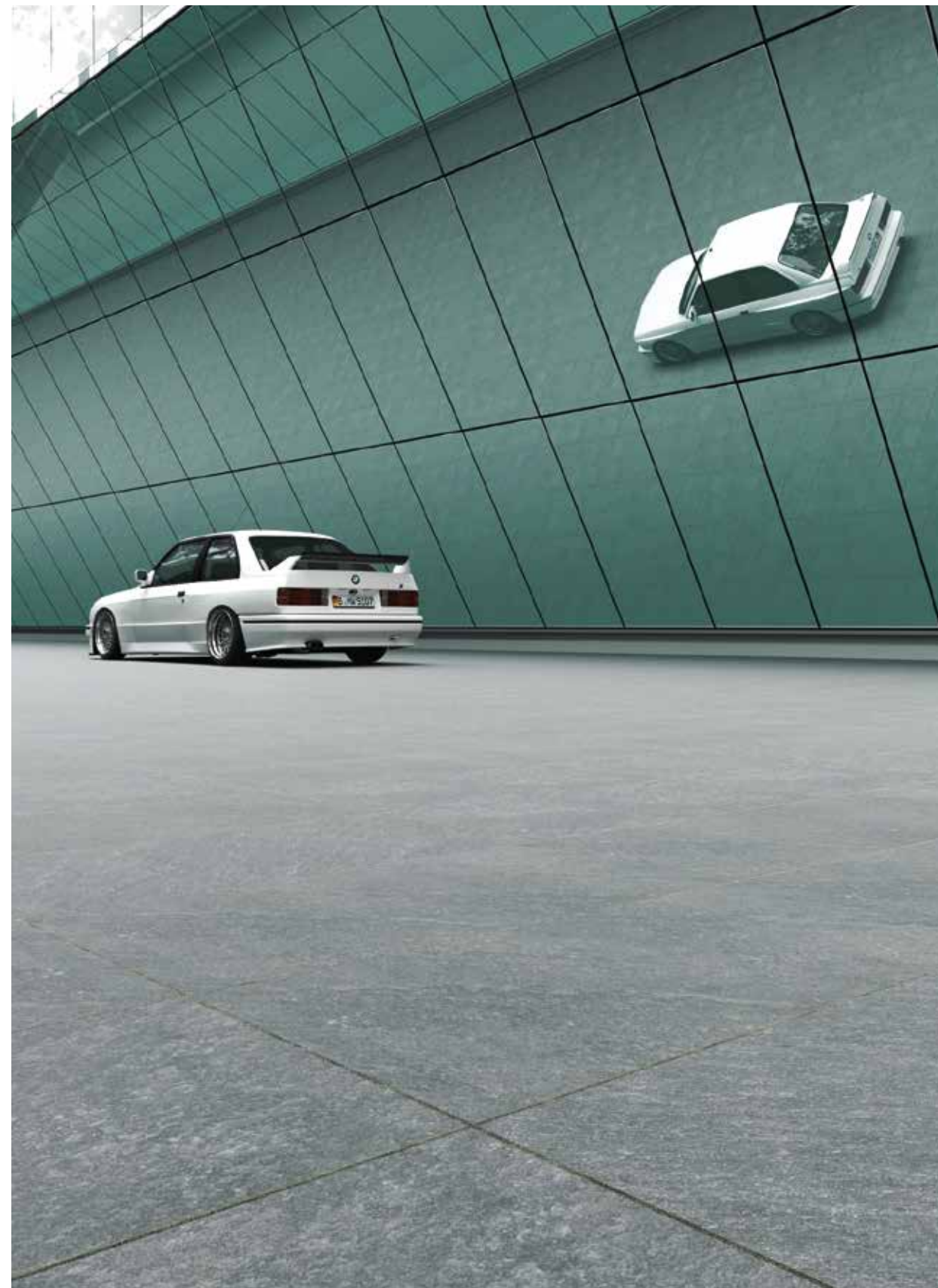



STAR  
3.0

STAR  
2.0

- pizarra
- danzig
- downtown
- downtown decor
- pietra serena
- select
- select decor
- suomi
- halifax
- vals
- spectre
- town

60x120 | 30x120 | 90x90 | 45x90 | 60x60  
24"x48" | 12"x48" | 36"x36" | 18"x36" | 24"x24"



60x120 | 90x90 | 60x60  
24"x48" | 36"x36" | 24"x24"

pizarra





grey



| size cm/in       | thickness mm/in | surface | ean code      | pei | anti-slip | no. of faces | rectified |
|------------------|-----------------|---------|---------------|-----|-----------|--------------|-----------|
| 60x120 / 24"x48" | 20 / 0,80"      | mat     | 5901503220429 | IV  | R11       | 6            | ✓         |
| 90x90 / 36"x36"  | 30 / 1,20"      | mat     | 5901503218679 | IV  | R11       | 9            | ✓         |
| 60x60 / 24"x24"  | 30 / 1,20"      | mat     | 5901503210499 | IV  | R11       | 11           | ✓         |



dark grey



|                  |            |     |               |    |     |    |   |
|------------------|------------|-----|---------------|----|-----|----|---|
| 60x120 / 24"x48" | 20 / 0,80" | mat | 5901503220436 | IV | R11 | 6  | ✓ |
| 60x60 / 24"x24"  | 30 / 1,20" | mat | 5901503210505 | IV | R11 | 11 | ✓ |



antracite



|                  |            |     |               |    |     |    |   |
|------------------|------------|-----|---------------|----|-----|----|---|
| 60x120 / 24"x48" | 20 / 0,80" | mat | 5901503220443 | IV | R11 | 6  | ✓ |
| 90x90 / 36"x36"  | 30 / 1,20" | mat | 5901503218655 | IV | R11 | 9  | ✓ |
| 60x60 / 24"x24"  | 30 / 1,20" | mat | 5901503210512 | IV | R11 | 11 | ✓ |

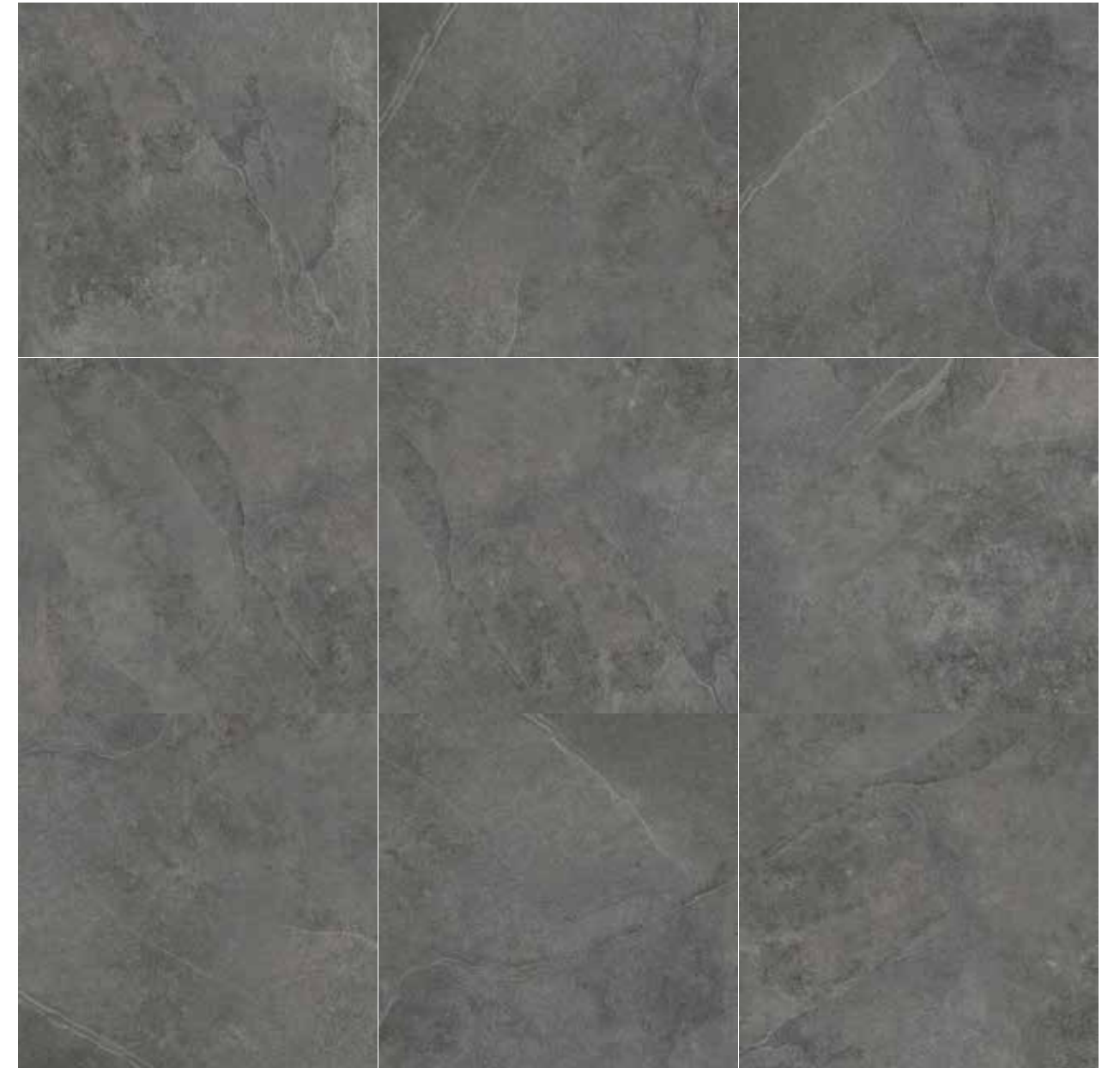

dark grey

60x60x3 / 24"x24"x1,20" 9 of 11 

90x90 | 45x90 | 60x60  
36"x36" | 18"x36" | 24"x24"

danzig





white



| size cm/in     | thickness mm/in | surface | ean code      | pei | anti-slip | no. of faces | rectified |
|----------------|-----------------|---------|---------------|-----|-----------|--------------|-----------|
| 60x60 / 24x24" | 20 / 0,80"      | mat     | 5901503206416 | IV  | R11       | 9            | ✓         |



natural



|                |            |     |               |    |     |   |   |
|----------------|------------|-----|---------------|----|-----|---|---|
| 60x60 / 24x24" | 20 / 0,80" | mat | 5901503206409 | IV | R11 | 9 | ✓ |
|----------------|------------|-----|---------------|----|-----|---|---|



taupe

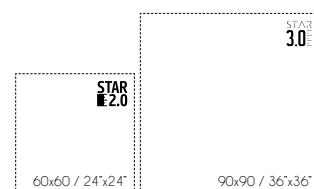

|                |            |     |               |    |     |   |   |
|----------------|------------|-----|---------------|----|-----|---|---|
| 90x90 / 36x36" | 30 / 1,20" | mat |               | IV | R11 |   | ✓ |
| 60x60 / 24x24" | 20 / 0,80" | mat | 5901503206447 | IV | R11 | 9 | ✓ |



taupe

60x60x2 / 24x24x0,80" 9 of 9





grey

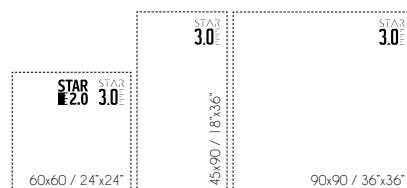

| size cm/in      | thickness mm/in | surface | ean code      | pei | anti-slip | no. of faces | rectified |
|-----------------|-----------------|---------|---------------|-----|-----------|--------------|-----------|
| 90x90 / 36"x36" | 30 / 1,20"      | mat     | 5901503218617 | IV  | R11       | 5            | ✓         |
| 45x90 / 18"x36" | 30 / 1,20"      | mat     | 5901503209882 | IV  | R11       | 6            | ✓         |
| 60x60 / 24"x24" | 30 / 1,20"      | mat     | 5901503207536 | IV  | R11       | 12           | ✓         |
| 60x60 / 24"x24" | 20 / 0,80"      | mat     | 5901503206423 | IV  | R11       | 9            | ✓         |



brown



|                 |            |     |               |    |     |    |   |
|-----------------|------------|-----|---------------|----|-----|----|---|
| 60x60 / 24"x24" | 20 / 0,80" | mat | 5901503209592 | IV | R11 | 9  | ✓ |
| 60x60 / 24"x24" | 30 / 1,20" | mat | 5901503207734 | IV | R11 | 12 | ✓ |



antracite

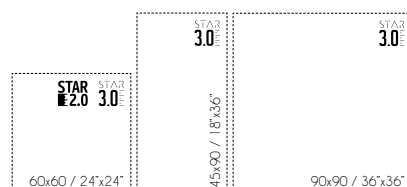

|                 |            |     |               |    |     |    |   |
|-----------------|------------|-----|---------------|----|-----|----|---|
| 90x90 / 36"x36" | 30 / 1,20" | mat | 5901503218631 | IV | R11 | 5  | ✓ |
| 45x90 / 18"x36" | 30 / 1,20" | mat | 5901503209899 | IV | R11 | 7  | ✓ |
| 60x60 / 24"x24" | 20 / 0,80" | mat | 5901503206430 | IV | R11 | 9  | ✓ |
| 60x60 / 24"x24" | 30 / 1,20" | mat | 5901503207550 | IV | R11 | 12 | ✓ |

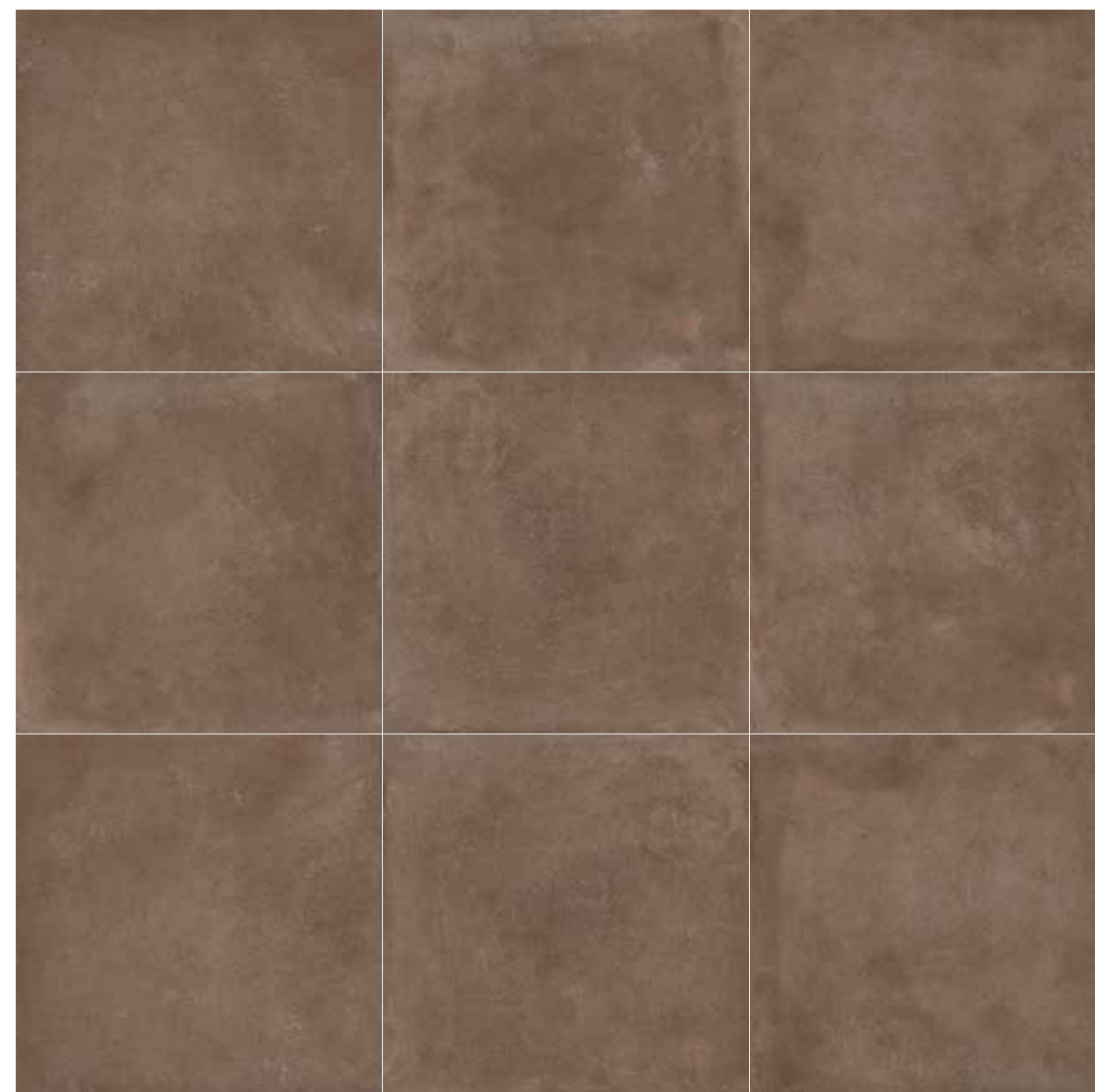

brown

60x60x2 / 24"x24"x0,80" 9 of 9



90x90 | 60x60  
36"x36" | 24"x24"

downtown



# downtown



grey



| size cm/in      | thickness mm/in | surface | ean code      | pei | anti-slip | no. of faces | rectified |
|-----------------|-----------------|---------|---------------|-----|-----------|--------------|-----------|
| 90x90 / 36"x36" | 30 / 1,20"      | mat     | 5901503218570 | IV  | R11       | 6            | ✓         |
| 60x60 / 24"x24" | 30 / 1,20"      | mat     | 5901503208144 | IV  | R11       | 12           | ✓         |
| 60x60 / 24"x24" | 20 / 0,80"      | mat     | 5901503203866 | IV  | R11       | 9            | ✓         |



decor



|                 |            |     |               |    |     |   |   |
|-----------------|------------|-----|---------------|----|-----|---|---|
| 90x90 / 36"x36" | 30 / 1,20" | mat | 5901503220375 | IV | R11 | 1 | ✓ |
|-----------------|------------|-----|---------------|----|-----|---|---|



taupe



|                 |            |     |               |    |     |    |   |
|-----------------|------------|-----|---------------|----|-----|----|---|
| 90x90 / 36"x36" | 30 / 1,20" | mat | 5901503218594 | IV | R11 | 7  | ✓ |
| 60x60 / 24"x24" | 30 / 1,20" | mat | 5901503208168 | IV | R11 | 12 | ✓ |
| 60x60 / 24"x24" | 20 / 0,80" | mat | 5901503203859 | IV | R11 | 9  | ✓ |



antracite



|                 |            |     |               |    |     |    |   |
|-----------------|------------|-----|---------------|----|-----|----|---|
| 90x90 / 36"x36" | 30 / 1,20" | mat | 5901503218198 | IV | R11 | 13 | ✓ |
| 60x60 / 24"x24" | 30 / 1,20" | mat | 5901503208151 | IV | R11 | 6  | ✓ |
| 60x60 / 24"x24" | 20 / 0,80" | mat | 5901503203873 | IV | R11 | 9  | ✓ |

# downtown



taupe

60x60x2 / 24"x24"x0,80" 9 of 9



60x120 | 30x120 | 45x90 | 60x60  
24"x48" | 12"x48" | 18"x36" | 24"x24"

pietra serena

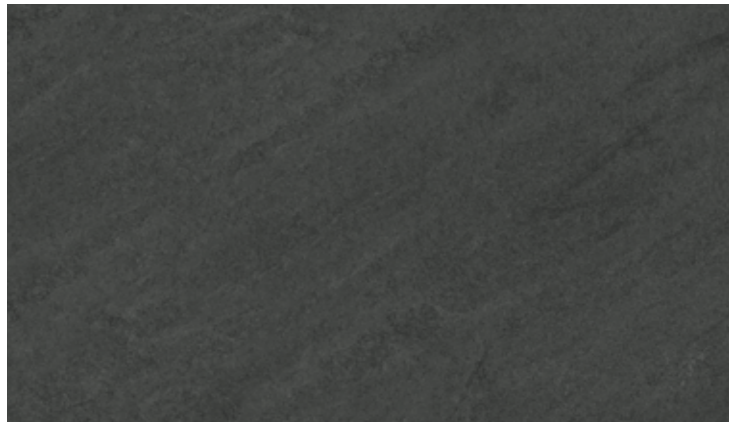



# pietra serena

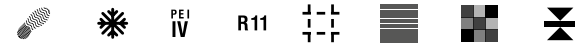

## cream



| size cm/in       | thickness mm/in | surface        | ean code      | pei | anti-slip | no. of faces | rectified |
|------------------|-----------------|----------------|---------------|-----|-----------|--------------|-----------|
| 60x120 / 24'x48" | 20 / 0,80"      | mat            | 5901503211243 | IV  | R11       | 6            | ✓         |
| 30x120 / 12'x48" | 20 / 0,80"      | mat step tiles | 5902706502817 | IV  | R11       | multi        | ✓         |
| 45x90 / 18'x36"  | 30 / 1,20"      | mat            | 5901503209691 | IV  | R11       | 6            | ✓         |
| 60x60 / 24'x24"  | 30 / 1,20"      | mat            | 5901503212080 | IV  | R11       | 6            | ✓         |
| 60x60 / 24'x24"  | 20 / 0,80"      | mat            | 5907641449982 | IV  | R11       | 6            | ✓         |



## grey



|                  |            |                |               |    |     |       |   |
|------------------|------------|----------------|---------------|----|-----|-------|---|
| 60x120 / 24'x48" | 20 / 0,80" | mat            | 5901503211229 | IV | R11 | 6     | ✓ |
| 30x120 / 12'x48" | 20 / 0,80" | mat step tiles | 5902706502824 | IV | R11 | multi | ✓ |
| 45x90 / 18'x36"  | 30 / 1,20" | mat            | 5901503209684 | IV | R11 | 6     | ✓ |
| 60x60 / 24'x24"  | 30 / 1,20" | mat            | 5901503212097 | IV | R11 | 6     | ✓ |
| 60x60 / 24'x24"  | 20 / 0,80" | mat            | 5907641446219 | IV | R11 | 6     | ✓ |



## antracite



|                  |            |                |               |    |     |       |   |
|------------------|------------|----------------|---------------|----|-----|-------|---|
| 60x120 / 24'x48" | 20 / 0,80" | mat            | 5901503211236 | IV | R11 | 6     | ✓ |
| 30x120 / 12'x48" | 20 / 0,80" | mat step tiles | 5902706502831 | IV | R11 | multi | ✓ |
| 45x90 / 18'x36"  | 30 / 1,20" | mat            | 5901503209677 | IV | R11 | 6     | ✓ |
| 60x60 / 24'x24"  | 30 / 1,20" | mat            | 5901503212110 | IV | R11 | 6     | ✓ |
| 60x60 / 24'x24"  | 20 / 0,80" | mat            | 5907641444321 | IV | R11 | 6     | ✓ |



## black



|                 |            |     |               |    |     |   |   |
|-----------------|------------|-----|---------------|----|-----|---|---|
| 60x60 / 24'x24" | 30 / 1,20" | mat | 5901503212103 | IV | R11 | 6 | ✓ |
| 60x60 / 24'x24" | 20 / 0,80" | mat | 5901503207192 | IV | R11 | 6 | ✓ |

# pietra serena



## cream

45x90x3 / 18'x36"x1,20" 4 of 6



## grey

45x90x3 / 18'x36"x1,20" 4 of 6



60x120 | 60x60  
24"x48" | 24"x24"

select



select



beige



| size cm/in       | thickness mm/in | surface | ean code      | pei | anti-slip | no. of faces | rectified |
|------------------|-----------------|---------|---------------|-----|-----------|--------------|-----------|
| 60x120 / 24"x48" | 20 / 0,80"      | mat     | 5901503216781 | IV  | R11       | 10           | ✓         |
| 60x60 / 24"x24"  | 30 / 1,20"      | mat     | 5901503215067 | IV  | R11       | 7            | ✓         |
| 60x60 / 24"x24"  | 20 / 0,80"      | mat     | 5901503216774 | IV  | R11       | 6            | ✓         |



soft grey



|                  |            |     |               |    |     |   |   |
|------------------|------------|-----|---------------|----|-----|---|---|
| 60x120 / 24"x48" | 20 / 0,80" | mat | 5901503220320 | IV | R11 | 7 | ✓ |
| 60x60 / 24"x24"  | 30 / 1,20" | mat | 5901503212127 | IV | R11 | 9 | ✓ |
| 60x60 / 24"x24"  | 20 / 0,80" | mat | 5901503220351 | IV | R11 | 9 | ✓ |



brown



|                  |            |     |               |    |     |   |   |
|------------------|------------|-----|---------------|----|-----|---|---|
| 60x120 / 24"x48" | 20 / 0,80" | mat | 5901503217047 | IV | R11 | 8 | ✓ |
| 60x60 / 24"x24"  | 30 / 1,20" | mat | 5901503215074 | IV | R11 | 6 | ✓ |
| 60x60 / 24"x24"  | 20 / 0,80" | mat | 5901503217030 | IV | R11 | 6 | ✓ |



antracite



|                  |            |     |               |    |     |   |   |
|------------------|------------|-----|---------------|----|-----|---|---|
| 60x120 / 24"x48" | 20 / 0,80" | mat | 5901503218402 | IV | R11 | 6 | ✓ |
| 60x60 / 24"x24"  | 30 / 1,20" | mat | 5901503212134 | IV | R11 | 9 | ✓ |
| 60x60 / 24"x24"  | 20 / 0,80" | mat | 5901503217948 | IV | R11 | 9 | ✓ |

select

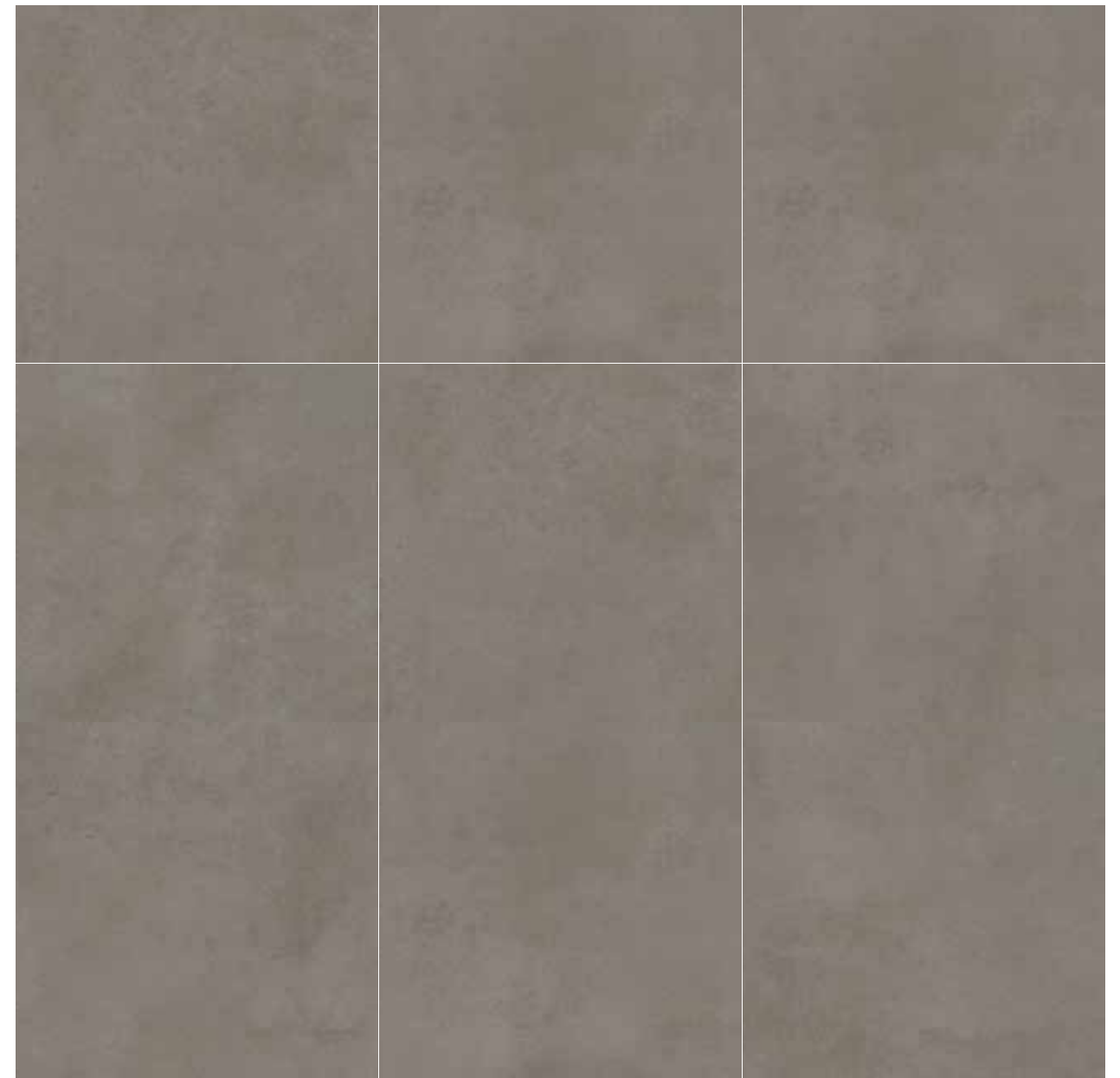

brown

60x60x2 / 24"x24"x0,80" 9 of 6



# select decor



terra



| size cm/in      | thickness mm/in | surface | ean code      | pei | anti-slip | no. of faces | rectified |
|-----------------|-----------------|---------|---------------|-----|-----------|--------------|-----------|
| 60x60 / 24"x24" | 30 / 1,20"      | mat     | 5901503219881 | IV  | R11       | 1            | ✓         |



blue



| size cm/in      | thickness mm/in | surface | ean code      | pei | anti-slip | no. of faces | rectified |
|-----------------|-----------------|---------|---------------|-----|-----------|--------------|-----------|
| 60x60 / 24"x24" | 30 / 1,20"      | mat     | 5901503219874 | IV  | R11       | 1            | ✓         |



grey



| size cm/in      | thickness mm/in | surface | ean code      | pei | anti-slip | no. of faces | rectified |
|-----------------|-----------------|---------|---------------|-----|-----------|--------------|-----------|
| 60x60 / 24"x24" | 30 / 1,20"      | mat     | 5901503219867 | IV  | R11       | 1            | ✓         |



45x90  
18"x36"

suomi





cream



45x90 / 18x36 30 / 1,20 mat 5901503209790 IV R11 9 ✓



brown



45x90 / 18x36 30 / 1,20 mat 5901503209783 IV R11 9 ✓



cream

45x90x3 / 18x36x1,20 4 of 9



brown

45x90x3 / 18x36x1,20 4 of 9

45x90  
18"x36"

halifax





natural



| size cm/in      | thickness mm/in | surface | ean code      | pei | anti-slip | no. of faces | rectified |
|-----------------|-----------------|---------|---------------|-----|-----------|--------------|-----------|
| 45x90 / 18"x36" | 30 / 1,20"      | mat     | 5901503214282 | IV  | R11       | 12           | ✓         |



gold



|                 |            |     |               |    |     |    |   |
|-----------------|------------|-----|---------------|----|-----|----|---|
| 45x90 / 18"x36" | 30 / 1,20" | mat | 5901503214299 | IV | R11 | 12 | ✓ |
|-----------------|------------|-----|---------------|----|-----|----|---|



natural

45x90x3 / 18"x36"x1,20" 4 of 12 



gold

45x90x3 / 18"x36"x1,20" 4 of 12 



45x90  
18"x36"

vals

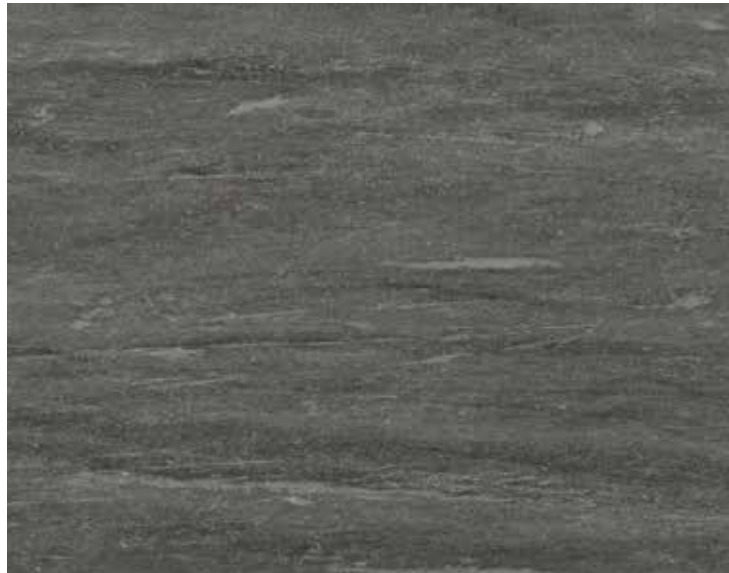



light



| size cm/in      | thickness mm/in | surface | ean code      | pei | anti-slip | no. of faces | rectified |
|-----------------|-----------------|---------|---------------|-----|-----------|--------------|-----------|
| 45x90 / 18"x36" | 30 / 1,20"      | mat     | 5901503212752 | IV  | R11       | 6            | ✓         |



grey



| size cm/in      | thickness mm/in | surface | ean code      | pei | anti-slip | no. of faces | rectified |
|-----------------|-----------------|---------|---------------|-----|-----------|--------------|-----------|
| 45x90 / 18"x36" | 30 / 1,20"      | mat     | 5901503212745 | IV  | R11       | 6            | ✓         |



dark



| size cm/in      | thickness mm/in | surface | ean code      | pei | anti-slip | no. of faces | rectified |
|-----------------|-----------------|---------|---------------|-----|-----------|--------------|-----------|
| 45x90 / 18"x36" | 30 / 1,20"      | mat     | 5901503212738 | IV  | R11       | 6            | ✓         |



grey

45x90x3 / 18"x36"x1,20" 4 of 6



dark

45x90x3 / 18"x36"x1,20" 4 of 6





grey



| size cm/in      | thickness mm/in | surface | ean code      | pei | anti-slip | no. of faces | rectified |
|-----------------|-----------------|---------|---------------|-----|-----------|--------------|-----------|
| 60x60 / 24"x24" | 30 / 1,20"      | mat     | 5901503207697 | IV  | R11       | 6            | ✓         |
| 60x60 / 24"x24" | 20 / 0,80"      | mat     | 5907641446448 | IV  | R11       | 6            | ✓         |



dark grey



|                 |            |     |               |    |     |   |   |
|-----------------|------------|-----|---------------|----|-----|---|---|
| 60x60 / 24"x24" | 30 / 1,20" | mat | 5901503207727 | IV | R11 | 7 | ✓ |
| 60x60 / 24"x24" | 20 / 0,80" | mat | 5907641446806 | IV | R11 | 7 | ✓ |



grey



soft grey



| size cm/in      | thickness  | surface | ean code      | pei | anti-slip | no. of faces | rectified |
|-----------------|------------|---------|---------------|-----|-----------|--------------|-----------|
| 60x60 / 24"x24" | 20 / 0,80" | mat     | 5901503202111 | IV  | R11       | 9            | ✓         |



beige



|                 |            |     |               |    |     |   |   |
|-----------------|------------|-----|---------------|----|-----|---|---|
| 60x60 / 24"x24" | 20 / 0,80" | mat | 5901503202142 | IV | R11 | 9 | ✓ |
|-----------------|------------|-----|---------------|----|-----|---|---|



grey

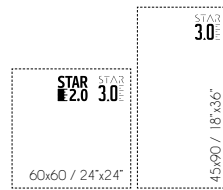

|                 |            |     |               |    |     |    |   |
|-----------------|------------|-----|---------------|----|-----|----|---|
| 45x90 / 18"x36" | 30 / 1,20" | mat | 5901503209837 | IV | R11 | 10 | ✓ |
| 60x60 / 24"x24" | 20 / 0,80" | mat | 5901503202128 | IV | R11 | 9  | ✓ |
| 60x60 / 24"x24" | 30 / 1,20" | mat | 5901503208021 | IV | R11 | 9  | ✓ |



antracite

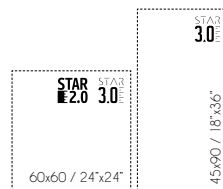

|                 |            |     |               |    |     |    |   |
|-----------------|------------|-----|---------------|----|-----|----|---|
| 45x90 / 18"x36" | 30 / 1,20" | mat | 5901503209820 | IV | R11 | 10 | ✓ |
| 60x60 / 24"x24" | 20 / 0,80" | mat | 5901503202135 | IV | R11 | 9  | ✓ |
| 60x60 / 24"x24" | 30 / 1,20" | mat | 5901503208045 | IV | R11 | 9  | ✓ |



beige

60x60x2 / 24"x24"x0,80" 9 of 9



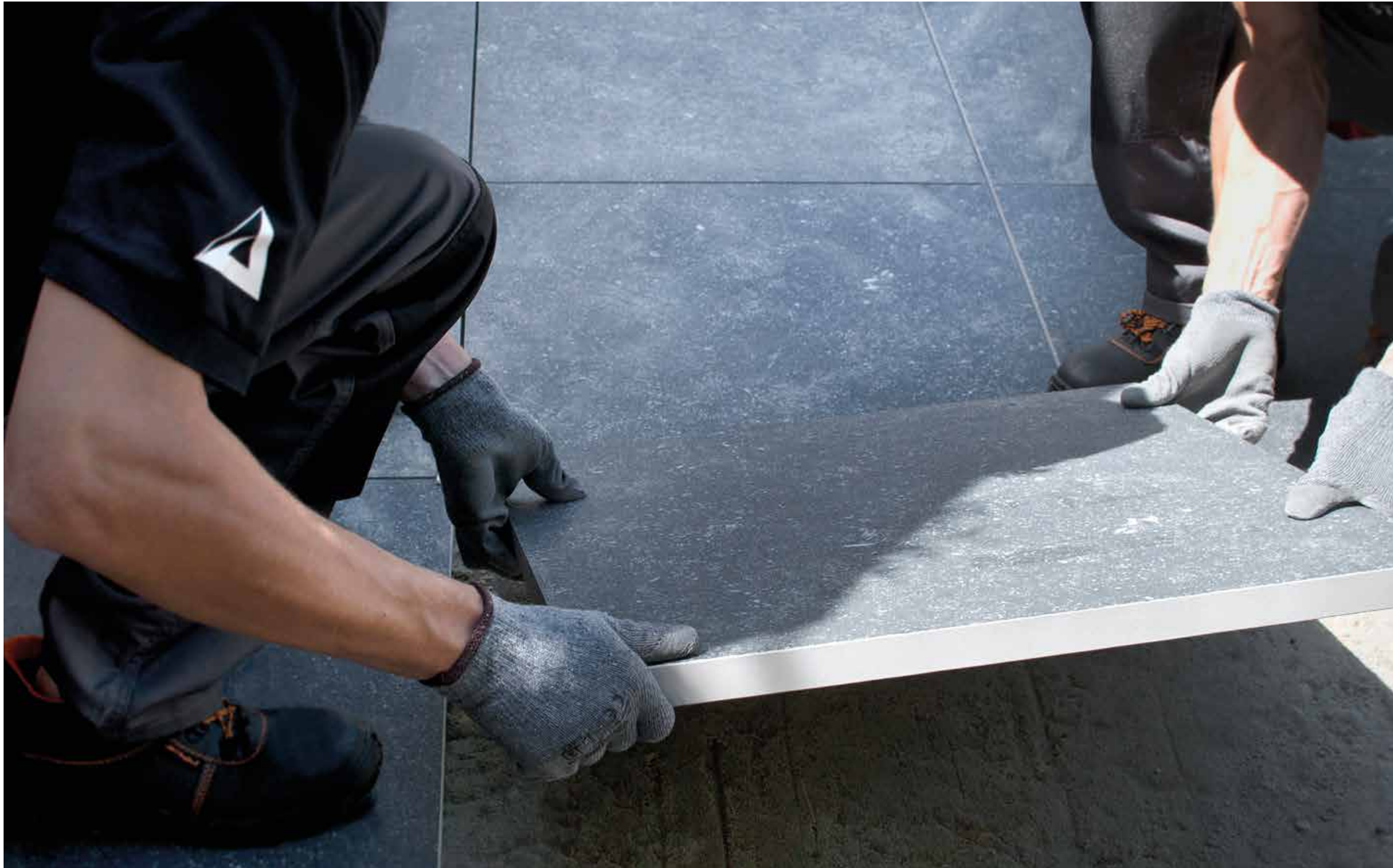

STAR  
3.0

STAR  
2.0

EASY AND QUICK ASSEMBLY

Gres Star 3.0 and 2.0 can be successfully laid on a hardened substrate without the use of adhesive, on pedestals or classically with a standard glue mortar for porcelain stoneware (gres).



PAVEMENTS



RAISED FLOOR



SWIMMING POOLS



BEACHES



GARDENS



TERRACES, PATIOS, BALCONIES

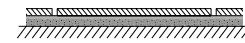
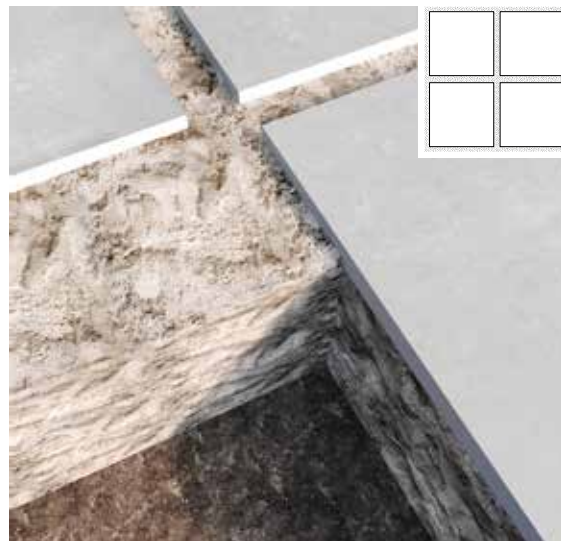

LAYING ON A SAND SUBSTRATE

SAND

STAR 3.0 or 2.0 gres slab

- ▶ Stabilizing layer (sand)
- ▶ Drainage layer
- ▶ Ground

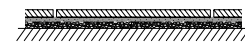
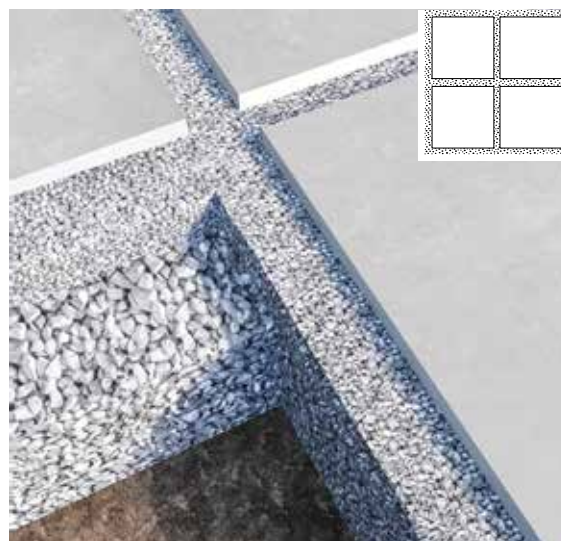

LAYING ON A GRAVEL SUBSTRATE

GRAVEL

STAR 3.0 or 2.0 gres slab

- ▶ Stabilizing layer (fine gravel)
- ▶ Drainage layer
- ▶ Ground

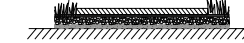
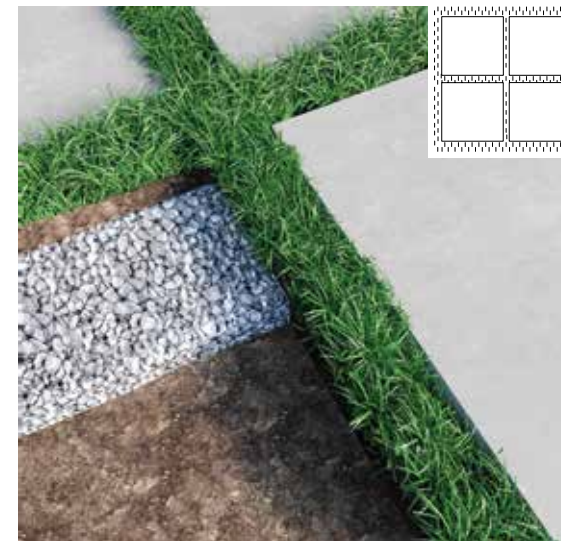

LAYING ON A GRASS SUBSTRATE

GRASS

STAR 3.0 or 2.0 gres slab

- ▶ Grass substrate layer
- ▶ Stabilizing layer (fine gravel)
- ▶ Drainage layer
- ▶ Ground

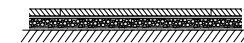
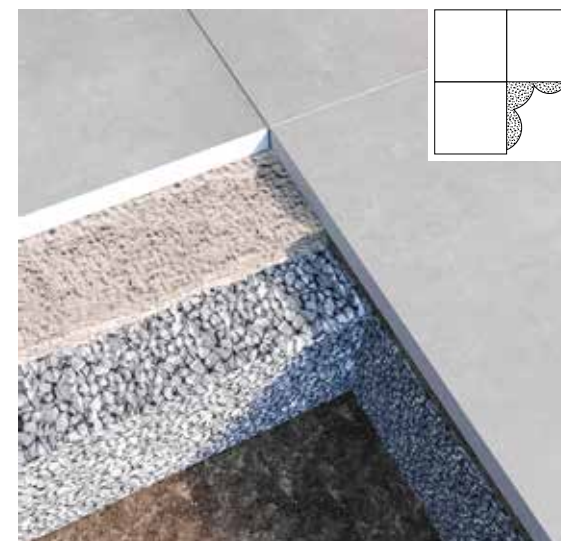

LAYING ON A TERRACE OR A DRIVEWAY

WATER-PERMEABLE SURFACE

STAR 3.0 or 2.0 gres slab

- ▶ Bedding, 3-5 cm / 1.2"-2" thick, after compaction (broken grit 2-5 mm / 0.08"-0.2" or washed sand 0-2 mm / 0"-0.08" or 0-4 mm / 0"-0.16" or dry concrete)
- ▶ The unbound substructure, 20-50 cm / 8"-20" thick, with a slope of 1.5-2% (crushed or broken stone, grain size 0-31.5 mm / 0"-12.5")
- ▶ Ground



PUBLIC SPACES  
PLAZAS



DRIVEWAYS



VEHICLE PATHS



INDUSTRIAL  
SPACES



STRENGTH  
min 3000 kg



VEHICLE PATHS  
UP TO 3.5 TONNES

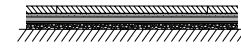
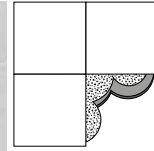

### LAYING ON A TERRACE OR A DRIVEWAY

POORLY PERMEABLE SURFACE

#### STAR 3.0 or 2.0 gres slab

- ▶ Bedding, 3-5 cm / 1.2"-2" thick, after compaction (broken grit 2-5 mm / 0.08"-0.2" or washed sand 0-2 mm / 0"-0.08" or 0-4 mm / 0"-0.16" or dry concrete)
- ▶ Stabilizing slab made of concrete of minimum B10 class, 20-60 cm / 8"-24" thick
- ▶ Geotextile
- ▶ The unbound substructure, 10-20cm/4"-8" thick, with a slope of 1.5-2% (crushed or broken stone, grain size 0-31.5 mm / 0"-12.5")
- ▶ Ground

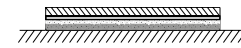
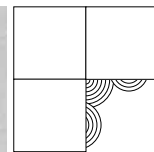

### LAYING ON A CONCRETE SUBSTRUCTURE WITH THE USE OF ADHESIVE

SUBSTRUCTURE

#### STAR 3.0 or 2.0 gres slab

- ▶ Adhesive layer
- ▶ Waterproofing layer
- ▶ Concrete bedding
- ▶ Concrete substructure layer (base layer)
- ▶ Ground

Expansion joints are required, and the gaps between the slabs must be filled with cement-based grout.

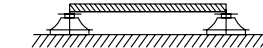
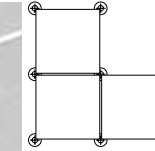

### RAISED FLOOR ON PEDESTAL SYSTEM

LARGE, REGULAR SURFACES (TERRACE, BALCONY)

#### STAR 3.0 or 2.0 gres slab

- ▶ Pedestal (fixed, adjustable or self-levelling)
- ▶ Waterproofing layer
- ▶ Concrete bedding

### WARNING

**We recommend using 5 pedestals for the installation: one on each corner and one in the middle of the gres slab.**

When installing 3 cm or 2 cm gres slabs as a raised floor system with pedestals, the slab may crack. Therefore, the manufacturer recommends checking the specific application before installation.

Under certain conditions, a 3 cm or 2 cm gres slab should be additionally reinforced with a layer of fiber mesh or a galvanized steel sheet. Failure to follow the instructions can lead to improper use of the product and cause damage or injury.

top view

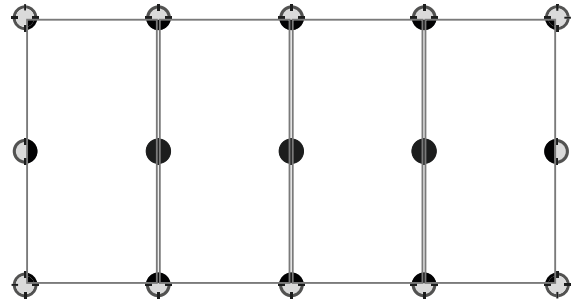

format 60x120 / 24"x48"

top view

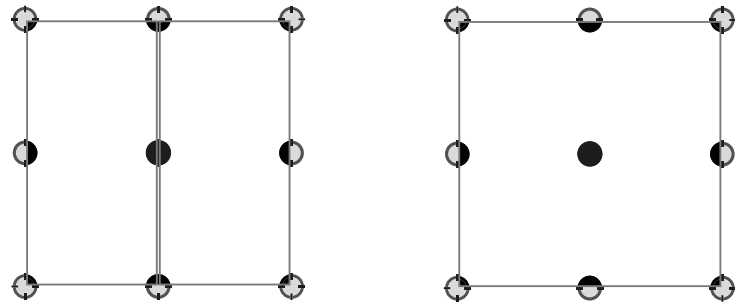

format 45x90 / 18"x36"

format 90x90 / 36"x36"

top view

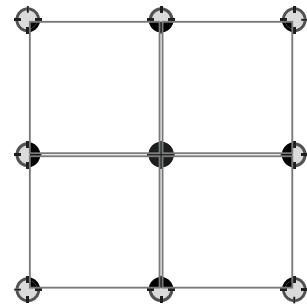

format 60x60 / 24"x24"

front/back view

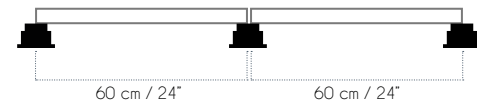

left/right view

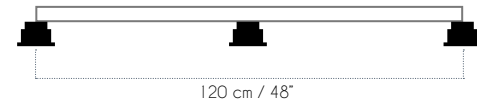

front/back view

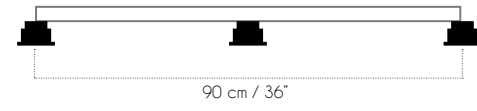
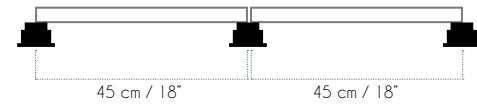

left/right view of the system

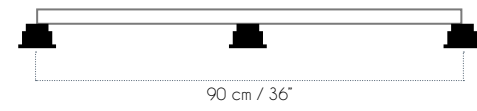

front/back view

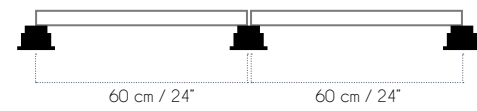

left/right view

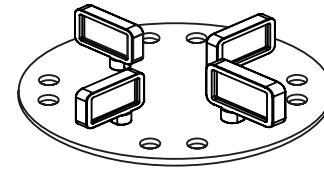
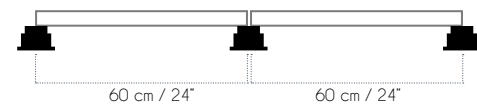

four gap spacer ring  
application on slab corners

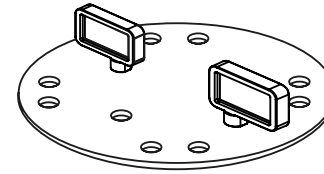

two gap spacer ring  
application along slab sides

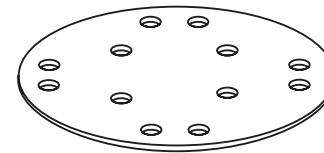

base gap spacer ring  
application in the middle of slab

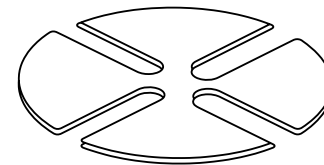

rubber shim  
application on top of the spacer ring

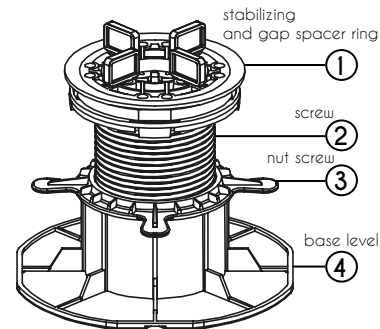

adjustable height pedestal scheme

dry installation on pedestals







RESISTANCE  
TO STAINS



DURABILITY  
AND STRENGTH



INSPIRE  
BY NATURE



GREATER  
STRENGTH



RESISTANCE  
TO SLIPPING



FROST  
RESISTANCE

**THE STAR 3.0 SERIES IS SUPERIOR TO NATURAL STONE AND CONCRETE SLABS THANKS TO:**

► **GREATER STRENGTH**

Thanks to its glazed surface, gres has a high strength and low abrasion resistance.

► **RESISTANCE TO STAINING AND EASY CLEANING**

To remove current dirt, simply use water and a brush. Impregnation is not necessary. Even grease or wine stains are not a problem when cleaning the slabs!

► **R11 RESISTANCE TO SLIPPING**

Excellent slipping resistance properties that guarantee safety for all users.

► **RESISTANCE TO ATMOSPHERIC CONDITIONS**

Excellent resistance to atmospheric conditions, including frost or solar radiation.

**WHY 3 CM?**

The innovative **thickness** of the **STAR 3.0** series slabs amounting to **3 cm** guarantees a number of advantages.

First of all, **50% higher weight means 50% more stability!**

► **RESISTANCE TO STAINS**

The surface of gres slabs is resistant to mold, moss and chemicals.

► **DURABILITY AND STRENGTH**

Breaking force higher than for 2 cm tiles. The 3 cm thick terrace tiles can also be used on driveways and high traffic areas.

► **WE ARE INSPIRED BY NATURE**

Nature's creations were our inspiration when creating patterns for our terrace slabs collections. The uniqueness of natural stones, the warmth of wood and the austerity of concrete are the keystones of the Star 3.0 series. All of our products reproduce the characteristic features of natural stones and wood, so that they perfectly harmonize with these elements.





FROST  
RESISTANCE



RESISTANCE  
TO CHANGING  
TEMPERATURES  
AND ATMOSPHERIC  
CONDITIONS



RESISTANCE  
TO STAINS



RESISTANCE  
TO LOAD



DRY AND WET CLEAN-  
ING EASINESS



RESISTANCE  
TO STAINS  
AND CHEMICALS



RESISTANCE  
TO SCRATCHING



EASE OF ASSEMBLY  
AND DISASSEMBLY

## WHY CHOOSE STAR 2.0?:

**STARGRES** slabs coming in a thickness of 2 cm belong to the **STAR 2.0** system and are designed to be used wherever it is necessary to obtain surfaces with the highest strength standards. They are resistant to changing climatic conditions, strong sunlight, resistant to mold and moss. They have anti-slip properties, are frost-resistant and non-flammable.

The combination of excellent parameters and modern design makes the **STAR 2.0** systems suitable for various locations. They are ideal for use on balconies, terraces, driveways, patios, in alleys, gardens, on grass, sand and near swimming pools. The ease of installation makes them an ideal solution for the development of both private and public spaces.

## WHY CHOOSE STAR 2.0?:

- ▶ It is a perfect solution with exceptional aesthetics and usability at a good price for public and private spaces.
- ▶ The **STAR 2.0** Porcelain Gres is a wide range of formats, structures, surfaces, colors, finishes and laying methods.
- ▶ Simplicity of use, the possibility of quick replacement or removal, resistance to destructive loads, variable climatic conditions, i.e. temperature fluctuations, strong exposure to sunlight and resistance to moss, mold and chemicals are just some of the advantages for which it is worth to opt for **STAR 2.0**.
- ▶ **STAR 2.0** panels are frost-resistant, non-flammable, non-absorbent and do not succumb to the passage of time.
- ▶ Above all, it is an excellent choice for the surroundings of your house.

















packing  
technical parameters

# packing

| format cm/inch   | thickness mm/inch | Pcs / box | m <sup>2</sup> / sq ft box | Kg / lb box | Box / pallet | Kg / lb pallet | m <sup>2</sup> / sq ft pallet |
|------------------|-------------------|-----------|----------------------------|-------------|--------------|----------------|-------------------------------|
| 60x60 / 24"x24"  | 30 / 1,20"        | 1         | 0,36 / 3,87                | 25 / 55,10  | 40           | 1000 / 2204    | 14,4 / 155                    |
| 45x90 / 18"x36"  | 30 / 1,20"        | 1         | 0,40 / 4,36                | 28 / 61,71  | 32           | 910 / 2005,64  | 12,96 / 139,50                |
| 90x90 / 36"x36"  | 30 / 1,20"        | 1         | 0,81 / 8,72                | 56 / 123,46 | 20           | 1120 / 2468,48 | 16,20 / 174,38                |
| 60x60 / 24"x24"  | 20 / 0,80"        | 2         | 0,72 / 7,75                | 31 / 68,32  | 30           | 970 / 2137,88  | 21,6 / 232,50                 |
| 30x120 / 12"x48" | 20 / 0,80"        | 1         | 0,36 / 3,87                | 16 / 35,27  | 50           | 830 / 1829,32  | 18 / 193,70                   |
| 60x120 / 24"x48" | 20 / 0,80"        | 1         | 0,72 / 7,75                | 32 / 70,53  | 30           | 1000 / 2204    | 21,6 / 232,50                 |

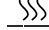
# technical parameters

| DIMENSION AND FLATNESS OF SURFACE<br>ABMESSUNGEN UND EBENHEIT DER FLÄCHE<br>РАЗМЕР И ПЛОСКОСТЬ ПОВЕРХНОСТИ |  | STANDARDS<br>NORMEN<br>НОРМЫ | N ≥ 15 cm   |   |                        |
|--|--|------------------------------|---|---|------------------------|
|  |  |                              | REQUIREMENTS<br>ANFORDERUNGEN<br>ТРЕБОВАНИЯ   | AVERAGE VALUE<br>ERZIELTER<br>DURCHSCHNITTSWERT<br>СРЕДНЕЕ                              |                        |
|                         | Length, Länge, Длина   | EN ISO 10545-2               | ± 0,6%  | ± 0,5%  |                        |
|  | Width, Breite, Ширина  |                              | ± 0,6%  | ± 0,5%  |                        |
|  | Thickness, Stärke, Толщина   |                              | ± 5% / 0,5 mm   | ± 3% / max 0,5 mm   |                        |
|  | Deviation of the angle<br>Abweichung vom Winkel<br>Отклонение от угла                                    |                              | ± 0,5% / 2mm  | ± 0,05% / max 2 mm  |                        |
|  | Surface flatness<br>Flächenebenheit<br>Плоскость поверхности   |                              | ± 0,5% / 2mm  | ± 0,2% / max 2 mm   |                        |
| PHYSICAL PROPERTIES<br>PHYSIKALISCHE EIGENSCHAFTEN<br>ФИЗИЧЕСКИЕ СВОЙСТВА                                  |  | STANDARDS<br>NORMEN<br>НОРМЫ | REQUIREMENTS<br>ANFORDERUNGEN<br>ТРЕБОВАНИЯ   | AVERAGE VALUE<br>ERZIELTER<br>DURCHSCHNITTSWERT<br>СРЕДНЕЕ                              |                        |
|                         | Water absorption<br>Wasseraufnahmevermögen<br>Водопоглощаемость  | EN ISO 10545-3               | E ≤ 0,5%  | 0,1% - 0,2%   |                        |
|                         | Breaking strength<br>Modulus of rupture<br>Bruchkraft<br>Преломляющая сила                               | EN ISO 10545-4               | for thickness, bei d. Stärke, для толщины<br>≥ 7,5 mm - ≥ 1300 N  | 30 MM   | 26 000 N               |
|  |  |                              |   | 20 MM   | 8500 N                 |
|                        | Modulus of rupture<br>Biegefestigkeit<br>Прочность при изгибе  | EN ISO 10545-4               | ≥ 35 N / mm <sup>2</sup>  | 30 MM   | 48 N / mm <sup>2</sup> |
|  |  |                              |   | 20 MM   | 43 N / mm <sup>2</sup> |
|                       | Abrasion resistance<br>Abriebfestigkeit<br>Стойкость к абразивному износу                                | EN ISO 10545-7               | according to the manufacturer's,<br>laut Herstellererklärung, согласно<br>декларации производителя  | PEI IV  |                        |
|                       | Resistance to thermal shock<br>Widerstand gegen Temperaturschock<br>Устойчивость к термическим нагрузкам | EN ISO 10545-9               | requirements<br>erforderlich<br>требуемая   | resistant<br>beständig<br>стойкие   |                        |
|                       | Cracking resistance<br>Rissbeständigkeit<br>Устойчивость к растрескиваниям шд                            | EN ISO 10545-11              | requirements<br>erforderlich<br>требуемая   | resistant<br>beständig<br>стойкие   |                        |
|                       | Frost resistance<br>Frostbeständigkeit<br>Морозостойкость  | EN ISO 10545-12              | Requirements<br>erforderlich<br>требуемая   | resistant<br>beständig<br>стойкие   |                        |
|                       | Chemical resistance<br>Chemische Beständigkeit<br>Химическая стойкость                                   | EN ISO 10545-13              | min. GB   | GLA, GHA, GA  |                        |
|                       | Resistance to spotting<br>Fleckempfindlichkeit<br>Стойкость к изменению цветового тона                   | EN ISO 10545-14              | min. 3 (GL)   | 5   |                        |
|                       | The release of lead and cadmium<br>Freisetzung von Blei und Cadmium<br>Высвобождение свинца и кадмия     | EN ISO 10545-15              | the requirements of Commission Directive,<br>Anforderungen der Richtlinie<br>требования директивы Комиссии -<br>2005/31/WE<br>≤ 0,2 mg/ l, Pb<br>≤ 0,02 mg/ l, Cd | 0<br>0  |                        |
|                       | Slip resistance<br>Rutschhemmung<br>Противоскользящие свойства   | DIN 51130                    | according to the manufacturer's,<br>laut Herstellererklärung, согласно<br>декларации производителя  | R11   |                        |
|                       | Natural radioactivity<br>Natürliche Radioaktivität<br>Естественная радиоактивность                       | ITB 455/2010                 | no requirements<br>keine Anforderungen<br>нет требований  | below admissible values, unterhalb<br>der zulässigen Werte, ниже<br>допустимых значений |                        |

VALUES ACCORDING / NORMWERTE / ЗНАЧЕНИЯ ЗА СТАНДАРТОМ  
PN EN 14411:2013-04

# display stands



**XXL - shelf system**

216 x 52 x 95 cm  
85" x 20,5" x 37,4"

250 kg  
551 lb



**RAMP - ramp system**

200 cm x 185 cm x 80 cm  
78,7" x 72,8" x 31,5"

325 kg  
716 lb



**SIMPLE - board system**

24 cm x 50 cm x 63 cm  
9,4" x 19,7" x 24,8"

5 kg  
11 lb



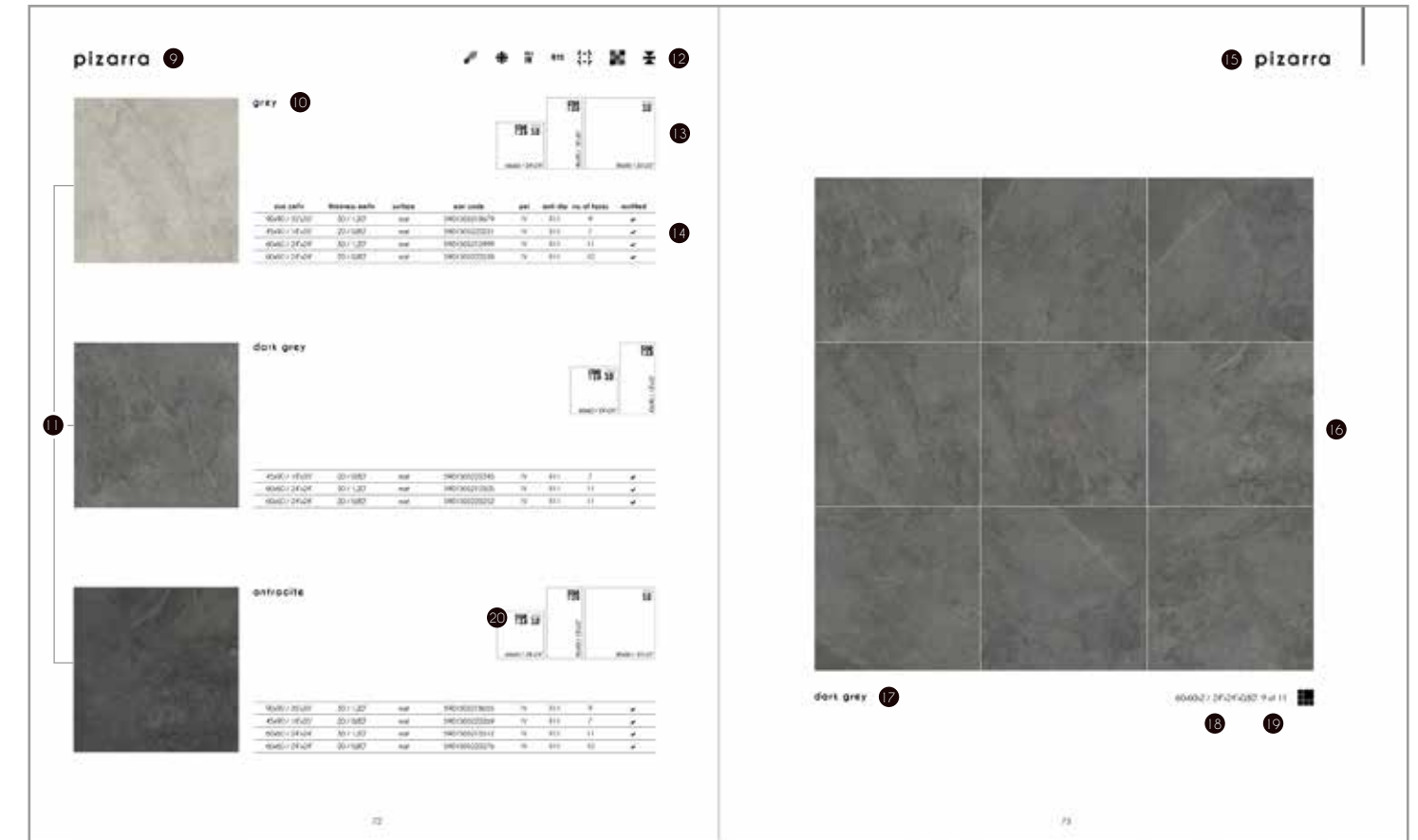
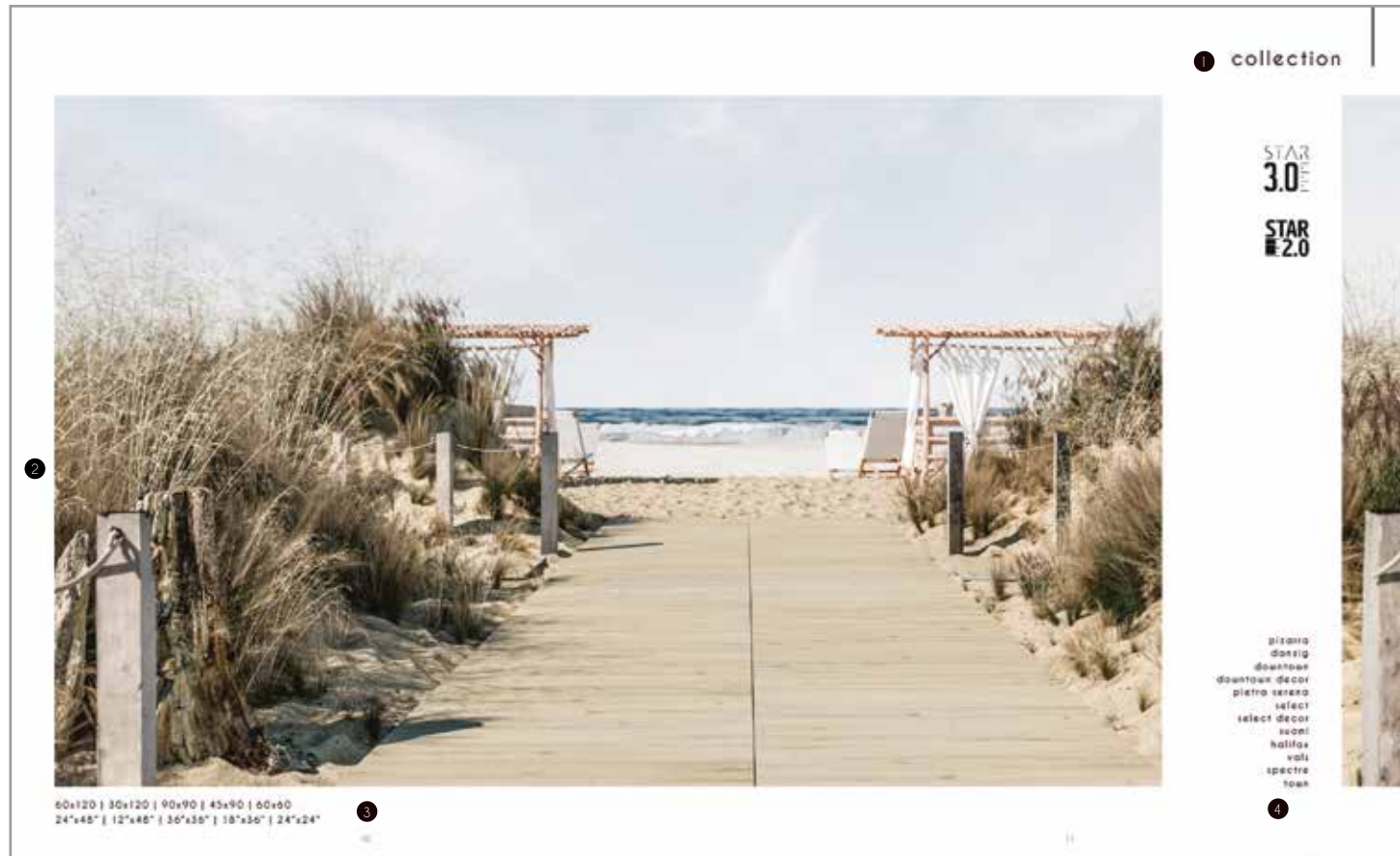

- 1 collection group
- 2 group cover
- 3 available formats
- 4 list of collections
- 5 collection name
- 6 available formats
- 7 color samples
- 8 collection cover
- 9 collection name
- 10 color name
- 11 color samples
- 12 tile properties pictograms
- 13 available formats
- 14 tile data table
- 15 collection name
- 16 face samples
- 17 color name
- 18 size cm/in
- 19 number of faces
- 20 format thickness

Without an explicit written consent of the Distributor no part of this catalogue may be copied in any form, which covers digital devices and information retrieval and storage systems. Modifications and changes to the products, technical specifications and the catalogue itself are forbidden. The colour of products may differ from the ones shown in the pictures due to limitations in the printing process.

► product destination

floor tile



abrasion resistance PEI

PEI  
IV

slip resistance R

R11

shade spectrum



number of sample faces



frost resistance



rectified



step tiles







STARGRES SP. Z O.O.

26-200 Końskie  
ul. Ceramiczna 5  
Poland

[www.stargres.pl](http://www.stargres.pl)